

Vtični T-kosa vrt., G 1/2 , zun. premera 16 mm

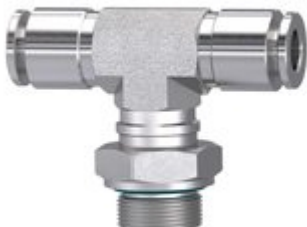

Kategorija: [Male branch tee, swivel type, parallel male thread](#)

Šifra: **135188RIE**

(slika je simbolična)

Kratek opis

Push-in T-fitting, rotating, G 1/2 o., for hose exterior Ø 16 mm, Working pressure -0.98 - 20 bar, Stainless steel 1.4404
For use in more aggressive environments and corrosive media.

The suitability test for the individual application is the user's responsibility.

Tehnične Specifikacije

Min. delovna temperatura [°C]	-20
Min. temperatura medija [°C]	-20
Min. delovni tlak [bar]	-0.98
Material	Stainless steel 1.4404
Navoj	G 1/2
Primerni materiali za cevi	PVDF, PTFE, PA, PU
Standardni navoj	DIN EN ISO 228-1
Tesnilo	FPM
Za cevi O.D. [mm]	16
Max. delovni tlak [bar]	20
a/f [mm]	27
L2 [mm]	39.6
L1 [mm]	60.0
Max. delovna temperatura [°C]	150
Max. temperatura medija [°C]	150