

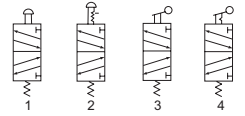

**»M5« Series**

515.1100–515.7104

Symbol

**Product features**

Traditional and robust valve series. Suitable for all applications where pneumatic actuators have to be operated. These valves are designed for in-line installation. Mounting in any position.

The following types are available:

- Two port sizes (1/8" and 1/4")
- 5/2-way version

**Valve's specification**

<b>Art. No.</b>	<b>515.1100, 515.2100, 515.3100, 515.4100–515.4102, 515.5100–515.5102, 515.6100–515.6102, 515.7101</b>	<b>515.1101, 515.2101, 515.3101, 515.4103–515.4105, 515.5103–515.5105, 515.6103–515.6105, 515.7104</b>
Fluid	Air (to be filtered by $\leq 40 \mu\text{m}$ filter element)	
Operating	External control direct acting type	
Port size	1/8"	1/4"
Valid area of section	9.0 mm <sup>2</sup> (Cv = 0.50)	12.0 mm <sup>2</sup> (Cv = 0.67)
Valve type	5 port 2 position	
Lubrication	Not required	
Pressure range	0 to 10 bar (0 to 1.0 MPa; 0 to 145 psi)	
Proof pressure	15 bar (1.5 MPa; 215 psi)	
Temperature	-20 to 70 °C	
Material of body	Aluminium alloy	
Flow rate measurement at P <sub>1</sub> = 8 bar, P <sub>2</sub> = 6 bar and pressure drop $\Delta p = 1$ bar	450 L/min	550 L/min

**Port identification pneumatic valves**

	Designation at the valve	Corresponds to ISO 1219-1
Input port	P	1
Output port	A	2
Output port	B	4
Exhaust port	R	3
Exhaust port	S	5
Control port	Y	12
Control port	Z	14

**Ordering information**

Art. No.	Type
515.1100–515.1101	5/2-way valve, manually operated, with long lever, monostable
515.2100–515.2101	5/2-way valve, manually operated, with short lever, monostable
515.3100–515.3101	5/2-way valve, manually operated, with rocker lever, bistable
515.4100–515.4105	5/2-way valve, manually operated, with pushbutton, monostable, for panel mounting
515.5100–515.5105	5/2-way valve, manually operated, with mushroom pushbutton, monostable, for panel mounting
515.6100–515.6105	5/2-way valve, manually operated, with short wing lever, monostable, for panel mounting
515.7101–515.7104	5/2-way valve, manually operated, with mushroom pushbutton and emergency latch, bistable, for panel mounting

»M5« Series

515.1100–515.7104

Flow chart

G 1/8"

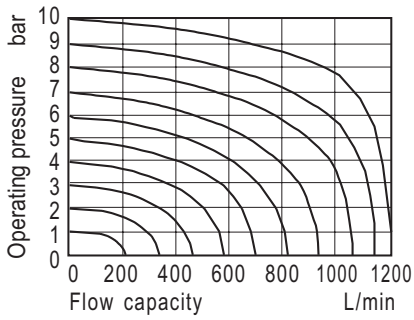

G 1/4"

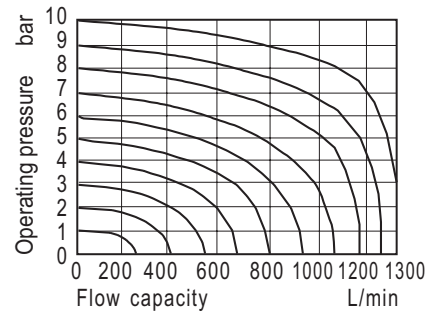

Body dimensions

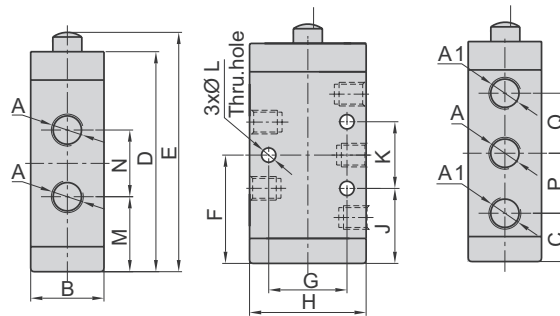

Art. No.	A	A1	B	C	D	E	F	G	H	J	K	L	M	N	P	Q
515.1100–	1/8"	1/8"	22	14.5	66	71.8	32.5	23.5	35	22.5	20	4.3	22.5	20	18	18
515.7104	1/4"	1/4"														

(Values in mm, exception A, A1 = inch)

Control set dimensions (mm)

515.1100, 515.1101

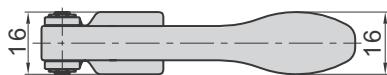

515.2100, 515.2101

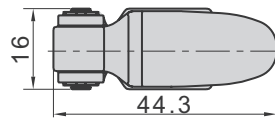

515.3100, 515.3101

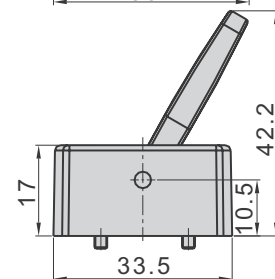
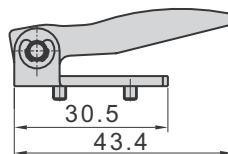
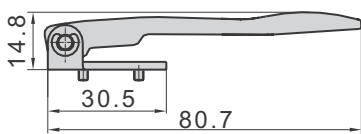
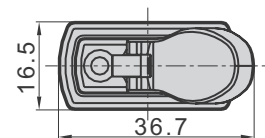

**»M5« Series**

515.1100–515.7104

**Control set dimensions (mm)**

515.4100–515.4105

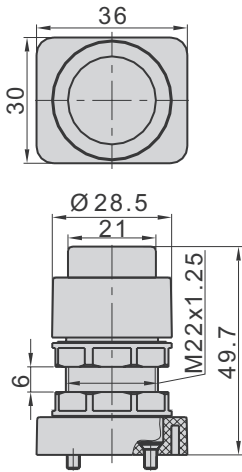

515.5100–515.5105

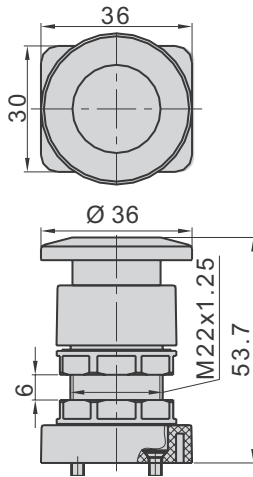

515.6100–515.6105

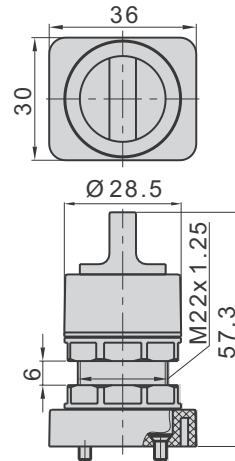

515.7101–515.7104

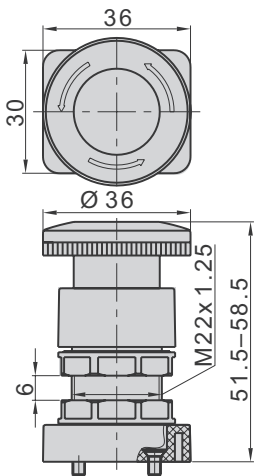
**Reversal stroke**

Art. No.	Spool stroke	Button/handle stroke
515.1100–515.1101	2.0 to 3.0	11.0 to 16.0
515.2100–515.2101	2.0 to 3.0	5.5 to 8.0
515.4100–515.4105	2.0 to 3.3	3.8 to 5.1
515.5100–515.5105	2.0 to 3.3	3.8 to 5.1
515.6100–515.6105	2.0 to 3.3	5.1 to 6.4
515.7101–515.7104	2.0 to 3.3	5.9 to 7.2

(Values in mm)

»M5« Series

515.1100-515.7104

Components and materials

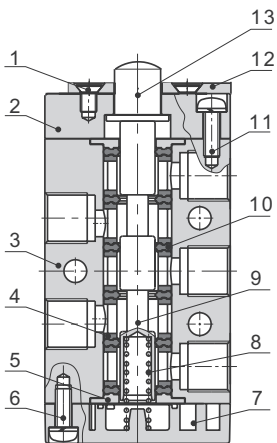

No.	Item	Material
1	Screw	Steel
2	Cover	Aluminium alloy
3	Body	Aluminium alloy
4	Spacer	POM
5	Centering bush	Aluminium alloy
6	Screw	Steel
7	Cover	Aluminium alloy
8	Spring	Stainless steel
9	Spool	Aluminium alloy
10	Spool O-ring	HNBR
11	Screw	Steel
12	Holder	Steel
13	Press bolt	Steel hardened

Assembly chart

Body mounting

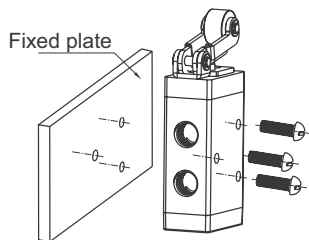

Panel mounting

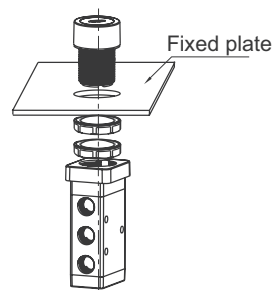

**Ordering information**

<b>Art. No.</b>	<b>Ident No.</b>
515.1100	115982
515.1101	115983
515.2100	115986
515.2101	115987
515.3100	115990
515.3101	115991
515.4100	115994
515.4101	115995
515.4102	115996
515.4103	115997
515.4104	115998
515.4105	115999
515.5100	116006
515.5101	116007
515.5102	116008
515.5103	116009
515.5104	116010
515.5105	116011
515.6100	116018
515.6101	116019
515.6102	116020
515.6103	116021
515.6104	116022
515.6105	116023
515.7101	116030
515.7104	116031